

## QVLC-SF-1

### SMA, DC~18GHz

**Features:**

- \* Low VSWR
- \* No welding
- \* Reusable
- \* Easy installation

**Applications:**

- \* Laboratory Test

**Electrical**

Frequency:	DC~18GHz
VSWR:	1.3 max.
Impedance:	50Ω

**Mechanical**

RF Conductor:	SMA Female
Inner Conductor:	Gold plated beryllium copper
Dielectric:	PTFE
Outer Conductor:	Nickel Plated Brass

**Environmental**

Temperature:	-55~+165°C
--------------	------------

**How To Order**

**QVLC-SF-1**

Customization is available upon request.

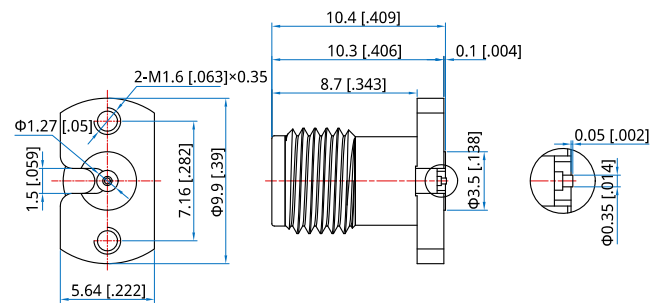
**Outline Drawings**

Unit: mm [in]

Tolerance:  $\pm 0.2\text{mm}$  [ $\pm 0.008\text{in}$ ]